



GOVERNMENT OF TAMIL NADU

IRRIGATED AGRICULTURAL MODERNISATION AND
WATER RESOURCES MANAGEMENT PROJECT

(IAMWARM)

POINEY SUB BASIN

**PUBLIC WORKS DEPARTMENT
WATER RESOURCES ORGANISATION**

TN IAMWARM PROJECT

DETAILED PROJECT REPORT

***ADDITIONAL PROPOSALS FOR REHABILITATION WORKS
IN RESPECT OF POINEY SUB BASIN***

PROJECT COST: Rs. 420.58 Lakhs

REGION	:	CHENNAI
PROJECT CIRCLE	:	VELLORE
UPPER PALAR BASIN DIVISION	:	VELLORE

ADDITIONAL PROPOSALS FOR PROVIDING LINING OF HEAD IRRIGATION CHANNEL AND FLOW MEASURING DEVICE IN POINEY SUB BASIN (PHASE –II) UNDER TN IAMWARM PROJECT

The lining of head irrigation channel and installation of Measuring device have been proposed for Phase I & II sub basins by utilizing the Project Savings as discussed with the World Bank, during the implementation support mission from Sept 12 - 20th 2011.

Accordingly, in Poiney subBasin of phase II the following works have been proposed.

- 1) Lining of head irrigation channel below the tanks sluice using C.C. M15 as per sketch enclosed
- 2) Installing flow measuring device in the head irrigation channel as per sketch
- 3) L.S provision of 2.80% for Provision of labour welfare @ 0.30% and provision for contingencies, advertisement charges, photographic charges @ 2.50%

The package details are appended separately and works are proposed to be taken up under national shopping procedure

The total cost for the DPR works out to Rs. 420.58 Lakhs.

FORMAT -I

Name of Region
Name of Circle

Chennai
Project circle, Vellore
Upper palar basin
division, Vellore
Poiney

Name of Division
Name of Subbasin

Total No of tanks taken up under
IAMWARM

142

No of tanks, sluices in each Package

Rs.in LAKHS

Sl. No	Package No.	Name of Tank	No of sluice	Flow measuring device		Head irrigation channel			Total amount	L.S.Provisions at 2.8 %	Grand total	Remarks
				Nos	Amount	Type of soil BC/OS	Length	Amount				
1	Package-1	Bommasamudram tank	2	2	0.26	OS	100	3.1	3.36	0.28	10.36	10.36
		Kanakkhangal tank	1	1	0.13	OS	50	1.55	1.68			
		Benduthangal tank	3	3	0.39	OS	150	4.65	5.04			
		Total	6	6	0.78		300	9.3	10.08			
2	Package-2	Veeraverthangal tank	1	1	0.13	OS	50	1.55	1.68	0.24	8.64	8.64
		Veppalai tank	4	4	0.52	OS	200	6.2	6.72			
		Total	5	5	0.65		250	7.75	8.4			
3	Package-3	Sripathanallur tank	3	3	0.39	OS	150	4.65	5.04	0.28	10.36	10.36
		Veeranthangal tank	3	3	0.39	OS	150	4.65	5.04			
		Total	6	6	0.78		300	9.3	10.08			
4	Package-4	Thenpalli tank	5	5	0.65	OS	250	7.75	8.4	0.28	10.36	10.36
		Kuppireddithangal tank	1	1	0.13	OS	50	1.55	1.68			
		Total	6	6	0.78		300	9.3	10.08			
5	Package-5	Abdulapuram tank	3	3	0.39	OS	150	4.65	5.04	0.28	10.36	10.36
		Elayanallur tank	3	3	0.39	OS	150	4.65	5.04			
		Total	6	6	0.78		300	9.3	10.08			
6	Package-6	Mahimandalam Chitteri	4	4	0.52	OS	200	6.2	6.72	0.28	10.36	10.36
		Surpenthangal tank	2	2	0.26	OS	100	3.1	3.36			
		Total	6	6	0.78		300	9.3	10.08			

7	Package-7	Kodukkanthangal tank	3	3	0.39	OS	150	4.65	5.04			
		Kumananthangal tank	3	3	0.39	OS	150	4.65	5.04			
		Total	6	6	0.78		300	9.3	10.08	0.28	10.36	10.36
8	Package-8	Maruthambakkam Big tank	3	3	0.39	OS	150	4.65	5.04			
		Maruthambakkam Onan eri	1	1	0.13	OS	50	1.55	1.68			
		Velanthangal tank	1	1	0.13	OS	50	1.55	1.68			
		Kattarikuppam tank	1	1	0.13	OS	50	1.55	1.68			
		Total	6	6	0.78		300	9.3	10.08	0.28	10.36	10.36
9	Package-9	Maruthambakkam Pudu eri	3	3	0.39	OS	150	4.65	5.04			
		Ekambaranallur tank	3	3	0.39	OS	150	4.65	5.04			
		Total	6	6	0.78		300	9.3	10.08	0.28	10.36	10.36
10	Package-10	Seekarajapuram tank	6	6	0.78	OS	300	9.3	10.08			
		Total	6	6	0.78		300	9.3	10.08	0.28	10.36	10.36
11	Package-11	Lalapettai Big tank	3	3	0.39	OS	150	4.65	5.04			
		Lalapettai Moongavel eri	1	1	0.13	OS	50	1.55	1.68			
		Lalapettai Kilorodai	2	2	0.26	OS	100	3.1	3.36			
		Total	6	6	0.78		300	9.3	10.08	0.28	10.36	10.36
12	Package-12	Lalapettai Kanjan eri	1	1	0.13	OS	50	1.55	1.68			
		Lalapettai Maveri	2	2	0.26	OS	100	3.1	3.36			
		Thagarakuppam tank	1	1	0.13	OS	50	1.55	1.68			
		Chengalnatham tank	2	2	0.26	OS	100	3.1	3.36			
		Total	6	6	0.78		300	9.3	10.08	0.28	10.36	10.36
13	Package-13	Gugainallur tank	4	4	0.52	OS	200	6.2	6.72			
		Sembarayanallur tank	2	2	0.26	OS	100	3.1	3.36			
		Total	6	6	0.78		300	9.3	10.08	0.28	10.36	10.36
14	Package-14	Eranthangal tank	3	3	0.39	OS	150	4.65	5.04			
		Kembarajapuram tank	2	2	0.26	OS	100	3.1	3.36			
		Total	5	5	0.65		250	7.75	8.4	0.24	8.64	8.64
15	Package-15	Vanapadi tank	5	5	0.65	OS	250	7.75	8.4			
		Total	5	5	0.65		250	7.75	8.4	0.24	8.64	8.64
16	Package-16	Chittithangal tank	1	1	0.13	OS	50	1.55	1.68			
		Ammoor tank	2	2	0.26	OS	100	3.1	3.36			
		Total	3	3	0.39		150	4.65	5.04	0.14	5.18	5.18
17	Package-17	Thandalam tank	2	2	0.26	OS	100	3.1	3.36			

		Manthangal tank	2	2	0.26	OS	100	3.1	3.36			
		Total	4	4	0.52		200	6.2	6.72	0.19	6.91	6.91
18	Package-18	Allikulam tank	2	2	0.26	OS	100	3.1	3.36			
		Chithathur tank	2	2	0.26	OS	100	3.1	3.36			
		Total	4	4	0.52		200	6.2	6.72	0.19	6.91	6.91
19	Package-19	Ozhugur tank	3	3	0.39	OS	150	4.65	5.04			
		Thalangai parikkal tank	1	1	0.13	OS	50	1.55	1.68			
		Total	4	4	0.52		200	6.2	6.72	0.19	6.91	6.91
20	Package-20	Sengadu tank	1	1	0.13	OS	50	1.55	1.68			
		Padiyambakkam tank	2	2	0.26	OS	100	3.1	3.36			
		Total	3	3	0.39		150	4.65	5.04	0.14	5.18	5.18
21	Package-21	Vanghur tank	1	1	0.13	OS	50	1.55	1.68			
		Vanghur putheri tank	1	1	0.13	OS	50	1.55	1.68			
		Total	2	2	0.26		100	3.1	3.36	0.09	3.45	3.45
22	Package-22	Ananthalai Big tank	1	1	0.13	OS	50	1.55	1.68			
		Ananthalai Anuppanthangal tank	1	1	0.13	OS	50	1.55	1.68			
		Ananthalai Illupanthangal	2	2	0.26	OS	100	3.1	3.36			
		Total	4	4	0.52		200	6.2	6.72	0.19	6.91	6.91
23	Package-23	Ammanthangal tank	2	2	0.26	OS	100	3.1	3.36			
		Chennasamudram tank	2	2	0.26	OS	100	3.1	3.36			
		Total	4	4	0.52		200	6.2	6.72	0.19	6.91	6.91
24	Package-24	Chekkadikuppam tank	1	1	0.13	OS	50	1.55	1.68			
		Jambukulam tank	1	1	0.13	OS	50	1.55	1.68			
		Rendadi tank	1	1	0.13	OS	50	1.55	1.68			
		Avaram tank	2	2	0.26	OS	100	3.1	3.36			
		Total	5	5	0.65		250	7.75	8.4	0.24	8.64	8.64
25	Package-25	Sholinghur tank	3	3	0.39	OS	150	4.65	5.04			
		Total	3	3	0.39		150	4.65	5.04	0.14	5.18	5.18
26	Package-26	Pandiyallur tank	2	2	0.26	OS	100	3.1	3.36			
		Total	2	2	0.26		100	3.1	3.36	0.09	3.45	3.45
27	Package-27	Kodaikkal tank	4	4	0.52	OS	200	6.2	6.72			
		Total	4	4	1.04		200	6.2	6.72	0.19	6.91	6.91
28	Package-28	Pulivalam tank	1	1	0.13	OS	50	1.55	1.68			
		Pulivalam perumanthangal	1	1	0.13	OS	50	1.55	1.68			
		Pulivalam Netteri	1	1	0.13	OS	50	1.55	1.68			
		Karikkal tank	1	1	0.13	OS	50	1.55	1.68			

		Total	4	4	0.52		200	6.2	6.72	0.19	6.91	6.91
29	Package-29	Melvenkatapuram tank	2	2	0.26	OS	100	3.1	3.36			
		Vadakatappanhangal tank	1	1	0.13	OS	50	1.55	1.68			
		Total	3	3	0.39		150	4.65	5.04	0.14	5.18	5.18
30	Package-30	Paranji tank	2	2	0.26	OS	100	3.1	3.36			
		Soorai tank	2	2	0.26	OS	100	3.1	3.36			
		Nandhimangalam tank	2	2	0.26	OS	100	3.1	3.36			
		Total	6	6	0.78		300	9.3	10.08	0.28	10.36	10.36
31	Package-31	Ayalthangal tank	1	1	0.13	OS	50	1.55	1.68			
		Ayalnagathangal tank	1	1	0.13	OS	50	1.55	1.68			
		Polipakkam tank	1	1	0.13	OS	50	1.55	1.68			
		Thappur tank	1	1	0.13	OS	50	1.55	1.68			
		Thappur Chitheri	1	1	0.13	OS	50	1.55	1.68			
		Vailambadi tank	1	1	0.13	OS	50	1.55	1.68			
		Total	6	6	0.78		300	9.3	10.08	0.28	10.36	10.36
32	Package-32	Vengupattu tank	1	1	0.13	OS	50	1.55	1.68			
		Methavadi tank	1	1	0.13	OS	50	1.55	1.68			
		Chithampadi tank	3	3	0.39	OS	150	4.65	5.04			
		Sembedu Soganur tank	1	1	0.13	OS	50	1.55	1.68			
		Total	6	6	0.78		300	9.3	10.08	0.28	10.36	10.36
33	Package-33	Thandalam tank	2	2	0.26	OS	100	3.1	3.36			
		Kilavanam tank	2	2	0.26	OS	100	3.1	3.36			
		Total	4	4	0.52		200	6.2	6.72	0.19	6.91	6.91
34	Package-34	Avadam Big tank	1	1	0.13	OS	50	1.55	1.68			
		Avadam small tank	1	1	0.13	OS	50	1.55	1.68			
		Vedal tank	1	1	0.13	OS	50	1.55	1.68			
		Total	3	3	0.39		150	4.65	5.04	0.14	5.18	5.18
35	Package-35	Melkalathur tank	3	3	0.39	OS	150	4.65	5.04			
		Paravathur tank	3	3	0.39	OS	150	4.65	5.04			
		Total	6	6	0.78		300	9.3	10.08	0.28	10.36	10.36
36	Package-36	Valarpuram tank				OS	50	1.55	1.55			
		Krishnapuram tank				OS	200	6.2	6.2			
		Uliyambakkam tank	1	1	0.13	OS	50	1.55	1.68			
		Total	1	1	0.13		300	9.3	9.43	0.26	9.69	9.69
37	Package-37	Polur Big tank	2	2	0.26	OS	100	3.1	3.36			
		Polur Chitteri	1	1	0.13	OS	50	1.55	1.68			
		Total	3	3	0.39		150	4.65	5.04	0.14	5.18	5.18

38	Package-38	Kilandur Big tank	1	1	0.13	OS	50	1.55	1.68			
		Kilandur chitteri	1	1	0.13	OS	50	1.55	1.68			
		Narayanamangalam tank	1	1	0.13	OS	50	1.55	1.68			
		Total	3	3	0.39		150	4.65	5.04	0.14	5.18	5.18
39	Package-39	Karpanthangal tank					50	1.55	1.55			
		Velur Hissa tank	2	2	0.26	OS	100	3.1	3.36			
		Mulvoy tank	1	1	0.13	OS	50	1.55	1.68			
		Total	3	3	0.39		200	6.2	6.59	0.18	6.77	6.77
40	Package-40	Kilpakkam tank	1	1	0.13	OS	50	1.55	1.68			
		Ammanur Therkeri	1	1	0.13	OS	50	1.55	1.68			
		Ammanur Vadakeri					50	1.55	1.55			
		Ammanur panavatteri					50	1.55	1.55			
		Ammanur Maveri	1	1	0.13	OS	50	1.55	1.68			
		Total	3	3	0.39		250	7.75	8.14	0.23	8.37	8.37
41	Package-41	Perumuchi Valayalkar eri	1	1	0.13	OS	50	1.55	1.68			
		Perumuchi Banal eri	2	2	0.26	OS	100	3.1	3.36			
		Total	3	3	0.39		150	4.65	5.04	0.14	5.18	5.18
42	Package-42	Athur small tank	1	1	0.13	OS	50	1.55	1.68			
		Athur Big tank	1	1	0.13	OS	0	0	0.13			
		Poyyapakkam thangal eri	2	2	0.26	OS	100	3.1	3.36			
		Poyyapakkam Moongil eri	2	2	0.26	OS	100	3.1	3.36			
		Cheyyur tank	1	1	0.13	OS	50	1.55	1.68			
		Total	7	7	0.91		300	9.3	10.21	0.29	10.50	10.5
43	Package-43	Devadanam tank	1	1	0.13	OS	50	1.55	1.68			
		Kilandurai tank	3	3	0.39	OS	200	6.2	6.59			
		Total	4	4	0.52		250	7.75	8.27	0.23	8.50	8.5
44	Package-44	Arumbakkam Big tank	3	3	0.39	OS	150	4.65	5.04			
		Arumbakkam velleri	2	2	0.26	OS	100	3.1	3.36			
		Total	5	5	0.65		250	7.75	8.4	0.24	8.64	8.64
45	Package-45	Arumbakkam gunderi	2	2	0.26	OS	100	3.1	3.36			
		Sripathi tank	1	1	0.13	OS	50	1.55	1.68			
		Nagavedu tank	3	3	0.39	OS	150	4.65	5.04			

		Total	6	6	0.78		300	9.3	10.08	0.28	10.36	10.36
46	Package-46	Chitteri tank	2	2	0.26	OS	100	3.1	3.36			
		Melpakkam Big tank	3	3	0.39	OS	150	4.65	5.04			
		Melpakkam Vizhal eri	2	2	0.26	OS			0.26			
		Total	7	7	0.91		250	7.75	8.66	0.24	8.90	8.9
47	Package-47	Elathur Kalleri	4	4	0.52	OS	200	6.2	6.72			
		Total	4	4	0.52		200	6.2	6.72	0.19	6.91	6.91
48	Package-48	Elathur Anjan eri	3	3	0.39	OS	150	4.65	5.04			
		Ochalam tank	2	2	0.26	OS	100	3.1	3.36			
		Total	5	5	0.65		250	7.75	8.4	0.24	8.64	8.64
49	Package-49	Manamaduri tank	3	3	0.39	OS	150	4.65	5.04			
		Sillamandai tank	3	3	0.39	OS	150	4.65	5.04			
		Total	6	6	0.78		300	9.3	10.08	0.28	10.36	10.36
50	Package-50	Kilkalathur tank	2	2	0.26	OS	100	3.1	3.36			
		Sirunamalli tank	3	3	0.39	OS	150	4.65	5.04			
		Total	5	5	0.65		250	7.75	8.4	0.24	8.64	8.64
51	Package-51	Padi tank	3	3	0.39	OS	150	4.65	5.04			
		Pallavaram tank	3	3	0.39	OS	150	4.65	5.04			
		Total	6	6	0.78		300	9.3	10.08	0.28	10.36	10.36
		GRAND TOTAL	238	238	31.46		12200	378.20	409.12	11.46	420.58	
CERTIFICATE												
Certified that the tanks included in the originally approved DPR of Poiney subbasin allowne are consider now												
Cerified that the tanks works were not taken up under any project												
Cerified that the field /head Irrigation channel drawing type 1 is adopted in 126 Nos of tanks having soil other than Black cotton soil												
Cerified that the field /head Irrigation channel drawing type 2 is adopted in none of the tanks having Black cotton soil												

FORMAT -II										
Name of Region			Chennai							
Name of Circle			Project circle,Vellore							
Name of Division			Upper palar basin division,Vellore							
Name of Subbasin			Poiney							
Total No of tanks taken up under IAMWARM			142							
Method of Procurement			National shopping							
(Note : Procurement plan to be got approved by World bank Separately)										
PACKAGEWISE ABSTRACT										
S.No	Package No.	Name of work	No of tanks	Total No of measuring devices	Total length of head irrigation channel	Total Amount including L.S.Provisions (Rs.in Lakhs)	Remarks			
1	2	3	4	5	6	7	8			
1	AP_01/IAMWARM/WRD/POY /WORKS II/2011-12	Lining of head irrigation channel and flow measuring device for kanakkanthangal tank and Benduthangal tank and Bommasamudram tank in katpadi taluk of vellore district	3	6	300	10.36				
2	AP_02/IAMWARM/WRD/POY /WORKS II/2011-12	Lining of head irrigation channel and flow measuring device for Veeraverthangal tank, Veppalai tank, in katpadi taluk of vellore district	2	5	250	8.64				
3	AP_03/IAMWARM/WRD/POY /WORKS II/2011-12	Lining of head irrigation channel and flow measuring device for Sripathanallur tank, Veeranthangal tank, in katpadi taluk of vellore district	2	6	300	10.36				
4	AP_04/IAMWARM/WRD/POY /WORKS II/2011-12	Lining of head irrigation channel and flow measuring device for Thenpalli tank, Kuppireddithangal tank in katpadi taluk of vellore district	2	6	300	10.36				

5	AP_05/IAMWARM/WRD/POY /WORKS II/2011-12	Lining of head irrigation channel and flow measuring device for Abdulapuram tank, Elayanallur tank in katpadi taluk of vellore district	2	6	300	10.36			
6	AP_06/IAMWARM/WRD/POY /WORKS II/2011-12	Lining of head irrigation channel and flow measuring device for Mahimandalam Chitteri Surpenthangal tank in katpadi taluk of vellore district	2	6	300	10.36			
7	AP_07/IAMWARM/WRD/POY /WORKSI/2011-12	Lining of head irrigation channel and flow measuring device for Kodukkanthangal tank, Kumananthangal tank in katpadi taluk of vellore district	2	6	300	10.36			
8	AP_08/IAMWARM/WRD/POY /WORKS II/2011-12	Lining of head irrigation channel and flow measuring device for Maruthambakkam Big tank, Maruthambakkam Onan eri , Velanthangal tank, Kattarikuppam tank in katpadi taluk of vellore district	4	6	300	10.36			
9	AP_09/IAMWARM/WRD/POY /WORKS II/2011-12	Lining of head irrigation channel and flow measuring device for Maruthambakkam Pudu eri, Ekambaranallur tank in katpadi taluk of vellore district	2	6	300	10.36			
10	AP_10/IAMWARM/WRD/POY /WORKS II/2011-12	Lining of head irrigation channel and flow measuring device for Seekarajapuram tank in katpadi taluk of vellore district	1	6	300	10.36			
11	AP_11/IAMWARM/WRD/POY /WORKS II/2011-12	Lining of head irrigation channel and flow measuring device for Lalapettai Big tank, Lalapettai Moongavel eri, Lalapettai Kilorodai in Walaja taluk of vellore district	3	6	300	10.36			
12	AP_12/IAMWARM/WRD/POY /WORKS II/2011-12	Lining of head irrigation channel and flow measuring device for Lalapettai Kanjan eri, Lalapettai Maveri Thagarakuppam tank, Chengalnatham tank in Walaja taluk of vellore district	4	6	300	10.36			
13	AP_13/IAMWARM/WRD/POY /WORKS II/2011-12	Lining of head irrigation channel and flow measuring device for Gugainallur tank, Sembarayanallur tank in Walaja taluk of vellore district	2	6	300	10.36			

14	AP_14/IAMWARM/WRD/POY /WORKS II/2011-12	Lining of head irrigation channel and flow measuring device for Eranthangal tank, Kembarajapuram tank in Walaja taluk of vellore district	2	5	250	8.64				
15	AP_15/IAMWARM/WRD/POY /WORKS II/2011-12	Lining of field channel and flow measuring device for Vanapadi tank in Walaja taluk of vellore district	1	5	250	8.64				
16	AP_16/IAMWARM/WRD/POY /WORKS II/2011-12	Lining of head irrigation channel and flow measuring device for Chittithangal tank, Ammoor tank in Walaja taluk of vellore district	2	3	150	5.18				
17	AP_17/IAMWARM/WRD/POY /WORKS II/2011-12	Lining of head irrigation channel and flow measuring device for Thandalam tank, Manthangal tank in Walaja taluk of vellore district	2	4	200	6.91				
18	AP_18/IAMWARM/WRD/POY /WORKS II/2011-12	Lining of head irrigation channel and flow measuring device for Allikulam tank, Chithathur tank in Walaja taluk of vellore district	2	4	200	6.91				
19	AP_19/IAMWARM/WRD/POY /WORKS II/2011-12	Lining of head irrigation channel and flow measuring device for Ozhugur tank, Thalangai parikkal tank in Walaja taluk of vellore district	2	4	200	6.91				
20	AP_20/IAMWARM/WRD/POY /WORKS II/2011-12	Lining of head irrigation channel and flow measuring device for Sengadu tank, Padiyambakkam tank in Walaja taluk of vellore district	2	3	150	5.18				
21	AP_21/IAMWARM/WRD/POY /WORKS II/2011-12	Lining of head irrigation channel and flow measuring device for Vanghur tank ,Vanghur putheri tank in Walaja taluk of vellore district	2	2	100	3.45				
22	AP_22/IAMWARM/WRD/POY /WORKS II/2011-12	Lining of head irrigation channel and flow measuring device for Ananthalai Big tank, Ananthalai Anuppanthangal tank, Ananthalai Illupanthangal in Walaja taluk of vellore district	3	4	200	6.91				

23	AP_23/IAMWARM/WRD/POY /WORKS II/2011-12	Lining of head irrigation channel and flow measuring device for Ammanthangal tank, Chennasamudram tank in Walaja taluk of vellore district	2	4	200	6.91			
24	AP_24/IAMWARM/WRD/POY /WORKS II/2011-12	Lining of head irrigation channel and flow measuring device for Chekkadikuppam tank, Jambukulam tank, Rendadi tank, in Walaja taluk of vellore district	4	5	250	8.64			
25	AP_25/IAMWARM/WRD/POY /WORKS II/2011-12	Lining of head irrigation channel and flow measuring device for Sholinghur tank in Walaja taluk of vellore district	1	3	150	5.18			
26	AP_26/IAMWARM/WRD/POY /WORKS II/2011-12	Lining of head irrigation channel and flow measuring device for Pandiyanallur tank in Walaja taluk of vellore district	1	2	100	3.45			
27	AP_27/IAMWARM/WRD/POY /WORKS II/2011-12	Lining of head irrigation channel and flow measuring device for Kodaikkal tank in Walaja taluk of vellore district	1	4	200	6.91			
28	AP_28/IAMWARM/WRD/POY /WORKS II/2011-12	Lining of head irrigation channel and flow measuring device for Pulivalam tank, Pulivalam perumanthangal, Pulivalam Netteri, Karikkal tank in Arakkonam taluk of vellore district	4	4	200	6.91			
29	AP_29/IAMWARM/WRD/POY /WORKS II/2011-12	Lining of head irrigation channel and flow measuring device for Melvenkatapuram tank, Vadakadappanthangal tank in Walaja taluk of vellore district	2	3	150	5.18			
30	AP_30/IAMWARM/WRD/POY /WORKS II/2011-12	Lining of head irrigation channel and flow measuring device for Parangi tank Soorai tank Nandhimangalam tank in Arakkonam taluk of vellore district	3	6	300	10.36			
31	AP_31/IAMWARM/WRD/POY /WORKS II/2011-12	Lining of head irrigation channel and flow measuring device for Ayalthangal tank, Ayalnagathangal tank, Polipakkam tank, Thappur tank, Thappur Chitheri Vailambadi tank in Arakkonam taluk of vellore district	6	6	300	10.36			
32	AP_32/IAMWARM/WRD/POY /WORKS II/2011-12	Lining of head irrigation channel and flow measuring device for Vengupattu tank,	4	6	300	10.36			

		Methavadi, tank Chithampadi tank, Sembedu Soganur tank in Arakkonam taluk of vellore district								
33	AP_33/IAMWARM/WRD/POY /WORKS II/2011-12	Lining of head irrigation channel and flow measuring device for Thandalam tank, Kilavanam tank in Arakkonam taluk of vellore district	2	4	200	6.91				
34	AP_34/IAMWARM/WRD/POY /WORKS II/2011-12	Lining of head irrigation channel and flow measuring device for Avadam Big tank Avadam small tank, Vedal tank in Arakkonam taluk of vellore district	3	3	150	5.18				
35	AP_35/IAMWARM/WRD/POY /WORKS II/2011-12	Lining of head irrigation channel and flow measuring device for Melkalathur tank, Paravathur tank in Arakkonam taluk of vellore district	2	6	300	10.36				
36	AP_36/IAMWARM/WRD/POY /WORKS II/2011-12	Lining of head irrigation channel and flow measuring device for Valarpuram tank, Krishnapuram tank, Uliyambakkam tank in Arakkonam taluk of vellore district	3	1	300	9.69				
37	AP_37/IAMWARM/WRD/POY /WORKS II/2011-12	Lining of head irrigation channel and flow measuring device for Polur Big tank, Polur Chitteri in Arakkonam taluk of vellore district	2	3	150	5.18				
38	AP_38/IAMWARM/WRD/POY /WORKS II/2011-12	Lining of head irrigation channel and flow measuring device for Kilandur Big tank, Kilandur chitteri ,Narayanamangalam tank in Arakkonam taluk of vellore district	3	3	150	5.18				
39	AP_39/IAMWARM/WRD/POY /WORKS II/2011-12	Lining of head irrigation channel and flow measuring device for Karpanthangal tank, Velur Hissa tank, Mulvoy tankin Arakkonam taluk of vellore district	3	3	200	6.77				
40	AP_40/IAMWARM/WRD/POY /WORKS II/2011-12	Lining of head irrigation channel and flow measuring device for Kilpakkam tank, Ammanur Therkeri, Ammanur Vadakeri, Ammanur panavatteri ,Ammanur Maveri in Arakkonam taluk of vellore district	5	3	250	8.37				

41	AP_41/IAMWARM/WRD/POY /WORKS II/2011-12	Lining of head irrigation channel and flow measuring device for Perumuchi Valayalkar eri, Perumuchi Banal eri in Arakkonam taluk of vellore district	2	3	150	5.18				
42	AP_42/IAMWARM/WRD/POY /WORKS II/2011-12	Lining of head irrigation channel and flow measuring device for Athur small tank, Athur Big tank ,Poyyapakkam thangal eri,Poyyapakkam Moongil eri ,Cheyyur tank in Arakkonam taluk of vellore district	5	7	300	10.5				
43	AP_43/IAMWARM/WRD/POY /WORKS II/2011-12	Lining of head irrigation channel and flow measuring device for Devadanam tank Kilandurai tank in Arakkonam taluk of vellore district	2	4	250	8.5				
44	AP_44/IAMWARM/WRD/POY /WORKS II/2011-12	Lining of head irrigation channel and flow measuring device for Arumbakkam Big tank, Arumbakkam velleri in Arakkonam taluk of vellore district	2	5	250	8.64				
45	AP_45/IAMWARM/WRD/POY /WORKS II/2011-12	Lining of head irrigation channel and flow measuring device for Arumbakkam gunderi, Sripathi tank, Nagavedu tankin Arakkonam taluk of vellore district	3	6	300	10.36				
46	AP_46/IAMWARM/WRD/POY /WORKS II/2011-12	Lining of head irrigation channel and flow measuring device for Chitteri tank, Melpakkam Big tank, Melpakkam Vizhal eri in Arakkonam taluk of vellore district	3	7	250	8.9				
47	AP_47/IAMWARM/WRD/POY/W ORKS II/2011-12	Lining of head irrigation channel and flow measuring device for Elathur Kalleri in Arakkonam taluk of vellore district	1	4	200	6.91				
48	AP_48/IAMWARM/WRD/POY /WORKS II/2011-12	Lining of head irrigation channel and flow measuring device for Elathur Anjan eri ,Ochalam tank in Arakkonam taluk of vellore district	2	5	250	8.64				
49	AP_49/IAMWARM/WRD/POY /WORKS II/2011-12	Lining of head irrigation channel and flow measuring device for Manamaduri tank, Sillamandai tank in Arakkonam taluk of vellore district	2	6	300	10.36				

50	AP_50/IAMWARM/WRD/POY /WORKS II/2011-12	Lining of head irrigation channel and flow measuring device for Kilkalathur tank ,Sirunamalli tank in Arakkonam taluk of vellore district	2	5	250	8.64			
51	AP_51/IAMWARM/WRD/POY /WORKS II/2011-12	Lining of head irrigation channel and flow measuring device for Padi tank,Pallavaram tank in Arakkonam taluk of vellore district	2	6	300	10.36			
		TOTAL	126	238	12200	420.58			

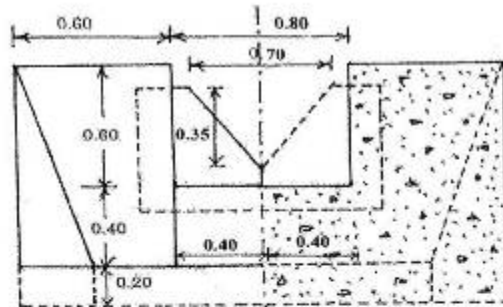

HALF FRONT ELEVATION AND HALF SECTIONAL ELEVATION AT 'C-C'

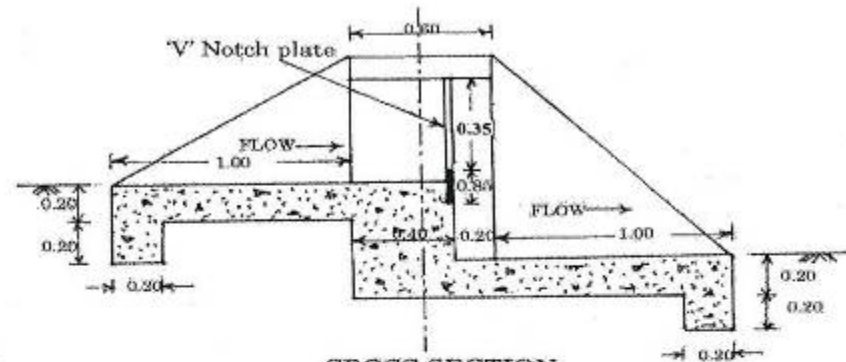

CROSS SECTION

TYPE - C
1 C/S/C V-NOTCH

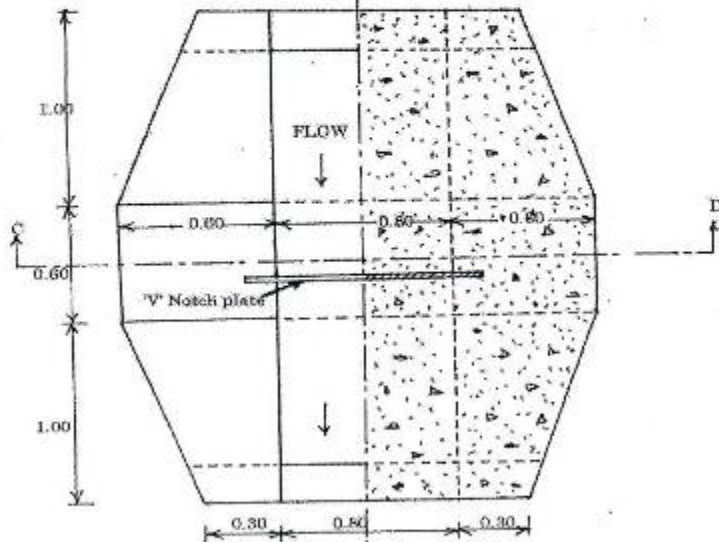

HALF PLAN AT TOP AND HALF PLAN AT BOTTOM

V-NOTCH - SALIENT DETAILS (For 1 to 4 C/s)

Discharge		Head Over Crest Cm	V-Notch size Cm	Overall size Cm
Cusec	Litre / sec			
1	26.3	20.5	25 x 50	50 x 85
2	56.6	27	30 x 60	50 x 75
3	85	32	35 x 70	55 x 90
4	113.27	36	42 x 84	60 x 100

IAMWARM PROJECT - PHASE IV
PARALAIYAR SUB BASIN
PROVIDING FLOW MEASURING
DEVICE (V-NOTCH) IN THE FIELD
CHANNEL OF TANK SLUICE
Scale :- 1cm = 0.25m
All dimension are in 'Metre'

TYPICAL CROSS SECTION OF LINED IRRIGATION CHANNEL

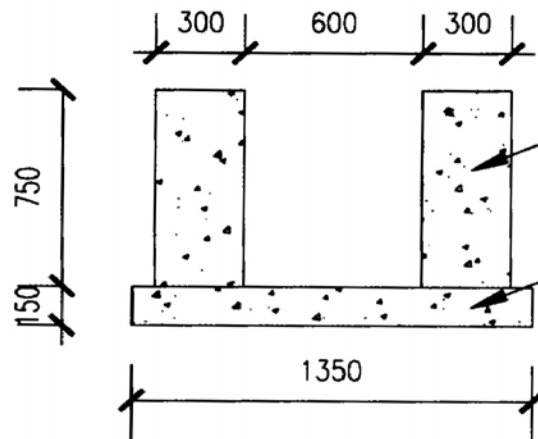

PCC M15 using aggregate
of maximum nominal size of 40 mm

PCC M15 using Down Graded Jelly

Note:--

Incase the site conditions necessitate increase
the Channel section requisite modifications be made
there-in duly ensuring the stability section

All Dimensions are in mm

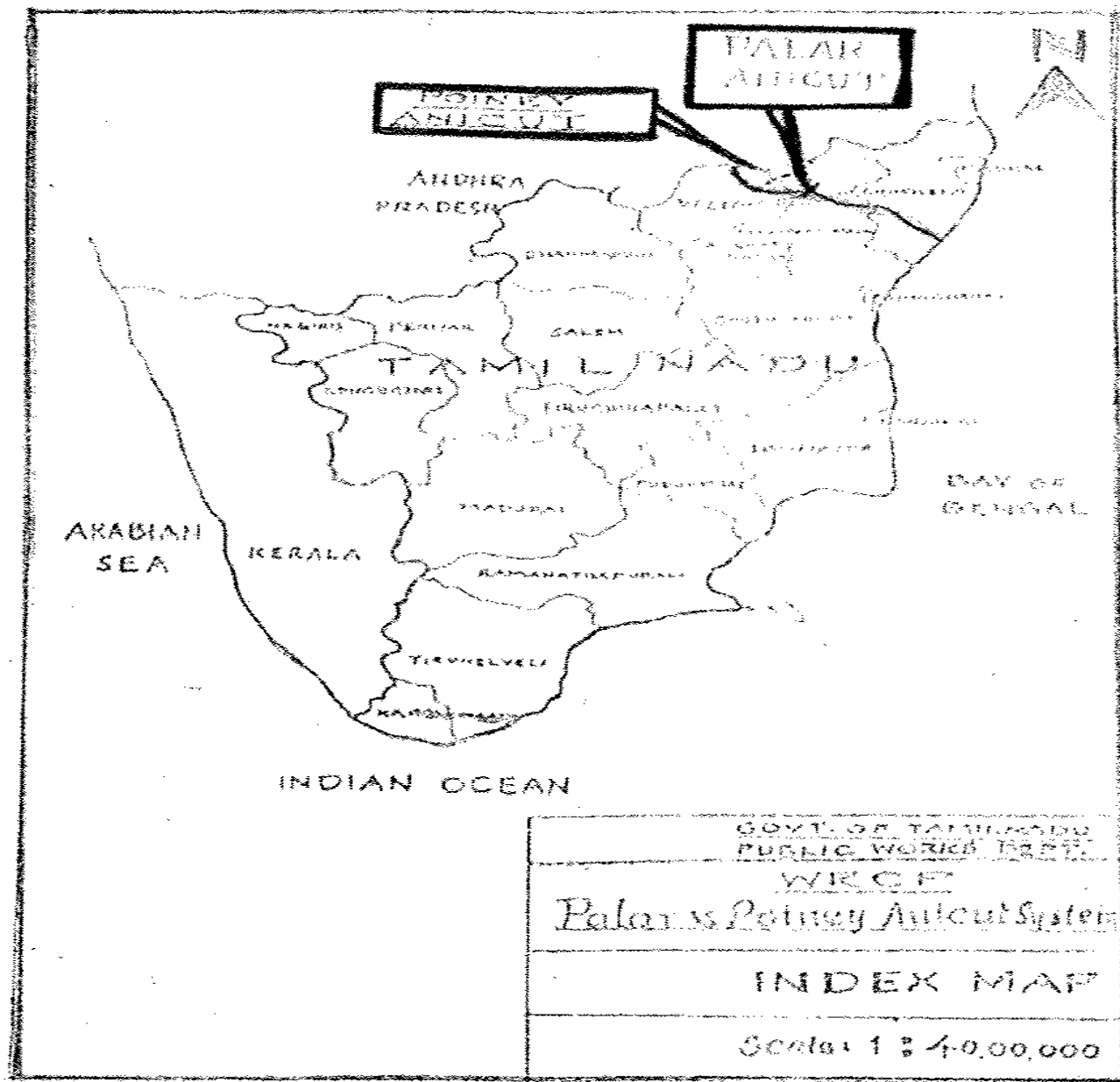

PALANIS POTTERY AULCUT

PALANIS POTTERY AULCUT

GOVT. OF TAMIL NADU PUBLIC WORKS DEPT.
W.R.C.E.
<i>Palanis Pottery Aulcut System</i>
INDEX MAP
Scale: 1 : 40,00,000

POINEY ANICUT SYSTEM

